

LET'S TALK

THE GOORNONG PLAN: DRAFT CONCEPT VISION

Get involved in developing a structure plan for Goornong!

The Goornong Plan will build upon the existing community strengths to achieve a liveable town for current and future residents.

The Plan will identify what opportunities exist and determine what facilities, services and infrastructure are needed to support that change, while respecting the existing character and qualities of Goornong.

What is a structure plan?

A **structure plan** is a Council document which provides guidelines for how a town should change and grow.

It includes guidance around streetscape improvements, and what should be maintained or protected. It can also set out where new residential expansion could occur and may even recommend planning scheme changes to allow certain commercial or industry growth.

A **community plan** is different in the sense that it is community led and includes things the community can do in terms of events for the town, opening new shops or heritage walk signage.

How were the concept maps developed?

Recently a community workshop was held in the township of Goornong. It involved participants undertaking a range of exercises to hear and share different community ideas around growth, what needs to be protected and what they see for the future of their town.

Following the workshop a series of draft concept maps and cross sections were prepared to reflect what the community discussed at the workshop.

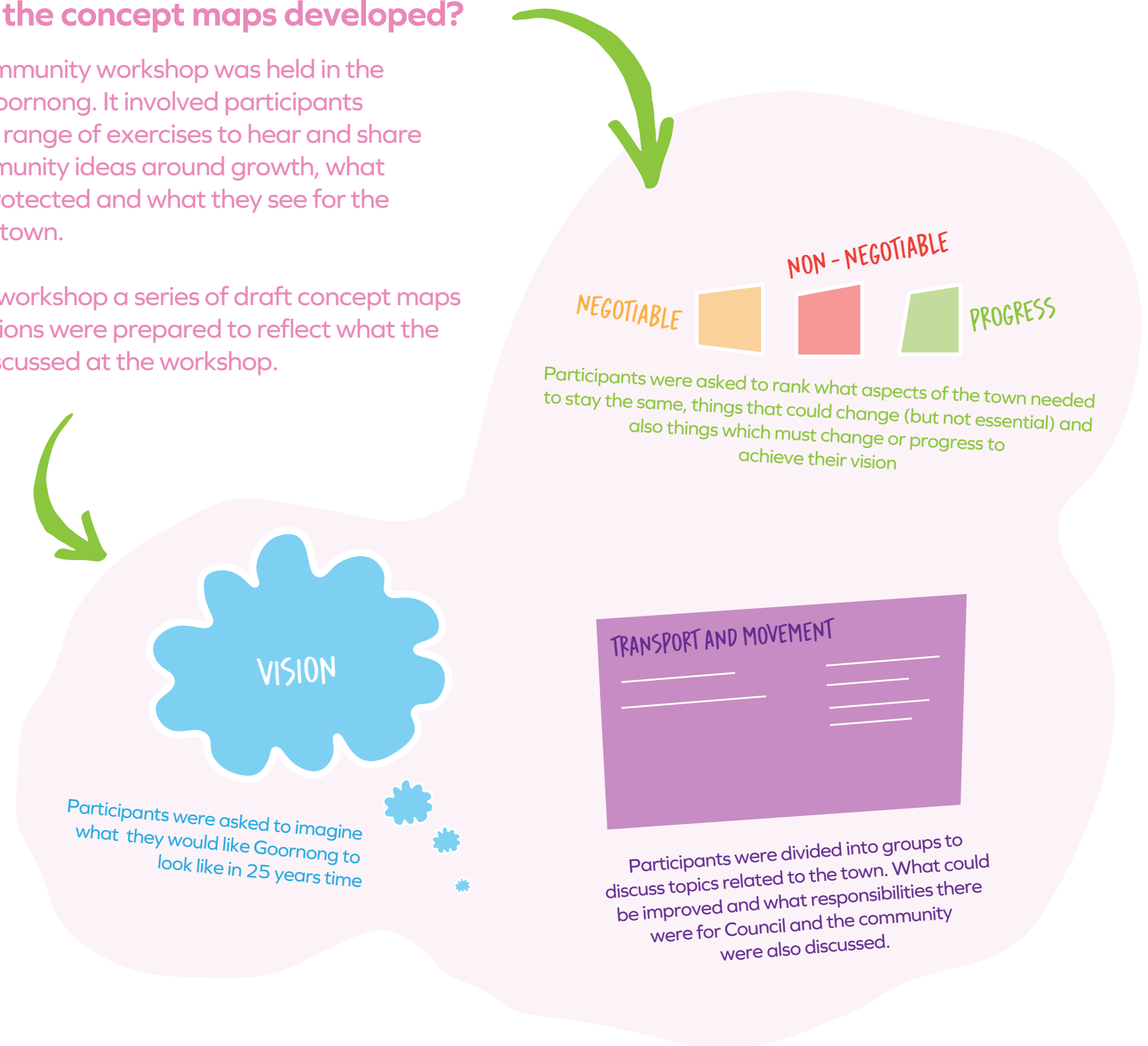

SETTLEMENT + LAND USE

This theme captures the communities desire for growth but also the need to protect what they love about their town (rural feel, large lots, peacefulness) The map shows:

- a clear township boundary to contain residential development and protect rural character and surrounding farming land
- opportunity within the existing residential area for large lot infill (1/2 acre)
- opportunities for residential expansion on the north, west and southern fringes (options only)
- a defined commercial activity area so shops and services are located together
- potential for smaller lots around commercial area

PUBLIC SPACE + ENVIRONMENT

This theme captures the need for suitably designed public space. The maps shows:

- opportunities to define main town entrances with plantings / sculptural artwork
- potential use of natural drainage techniques
- increased street tree plantings to create shaded walking route between station and rec reserve (Langdon and Chute)

TRANSPORT + MOVEMENT

This theme represents the communities need for safe roads and footpaths. The maps shows:

- priority walking and cycling links to school, rec reserve and train station
- primary east-west street for shaded walking and cycling (Grant Street)
- potential walking circuit and cycle connection to Englishs Bridge
- designated long vehicle parking

TOWN CENTRE CONCEPT

An attractive and active town centre with shops is important to community members. The concept shows:

- relocation of the southern bus stop to allow commercial development on vacant lots (small grocery store or cafe)
- provide opportunities for rear car parking or rear access to commercial buildings
- opportunity for laneway access between main street and Grant Street with smaller residential lot sizes
- a public gathering place outside of memorial hall with paving and plantings

KEY STREETSCAPE DESIGN

This theme represents the importance of suitable streetscapes for movement including:

- cross sections of key streets showing potential walking and cycling priorities
- local roads with various design treatments depending on the context, existing features and priority use (walking, cycling or vehicle)

DRAFT CONCEPT VISION

Following the workshop, a series of draft concept maps and cross sections have been prepared. These visuals reflect the emerging themes and township vision which was discussed at the workshop. The maps have been grouped into the themes above and detail potential changes and improvements.



Scan here to
submit a comment

GOORNONG TOWNSHIP

CURRENT CENSUS DATA :



326

139

NOTE: TOWN INFILL/EXPANSION OPTIONS ARE SUBJECT TO SEWER INFRASTRUCTURE/SERVICING BEING PROVIDED, WHICH OPTIONS MAY DEPEND ON THE OVERALL TOWN SIZE OBJECTIVE AND ON LOCALISED CONSTRAINTS

PROTECT SURROUNDING FARMLAND BY:

- A CLEARLY DEFINED TOWN BOUNDARY
- MAXIMISING USE OF THE EXISTING TOWN FOOTPRINT
- LOGICAL, TARGETED AND LIMITED TOWN EXPANSION

POTENTIAL LARGE LOT INFILL TO THE NORTH

MAINTAIN INDUSTRIAL LAND

OLD MURRAY ROAD

RAILWAY PLACE NORTH

STREET

TYLER STREET

GRANT

GOORNONG

BARNADOWN ROAD

POTENTIAL LARGE LOT INFILL WITHIN THE EXISTING TOWN

ENGLISHS ROAD

AXEDALE - GOORNONG ROAD

MIDLAND HIGHWAY

GOORNONG - POSTERVILLE ROAD

INCREASE DIVERSITY OF LOT SIZES AND HOUSING TYPES AROUND TOWN CENTRE

POTENTIAL LARGE LOT EXPANSION TO THE SOUTH BY EXTENDING STREET GRID

LEGEND

- Mix of smaller lot sizes and housing types
- Large lot infill (existing lots)
- Potential large lot expansion
- Community and civic uses
- Industrial land
- Sealed roads
- Township growth boundary
- Designated commercial area

GOORNONG STRUCTURE PLAN

SETTLEMENT + LAND USE



IMPROVE MOVEMENT AND SAFETY AROUND THE TOWN BY:

- PRIORITISING FOOTPATHS / CYCLE ROUTES TO KEY DESTINATIONS
- MAXIMISING USE OF THE EXISTING ROADWAYS AND LINKAGES
- INCLUDING TRAFFIC CALMING ROAD DESIGN ON LOCAL TOWNSHIP ROADS
- ENHANCE CURRENT WALKING TRACKS WITH IMPROVED CONNECTIONS

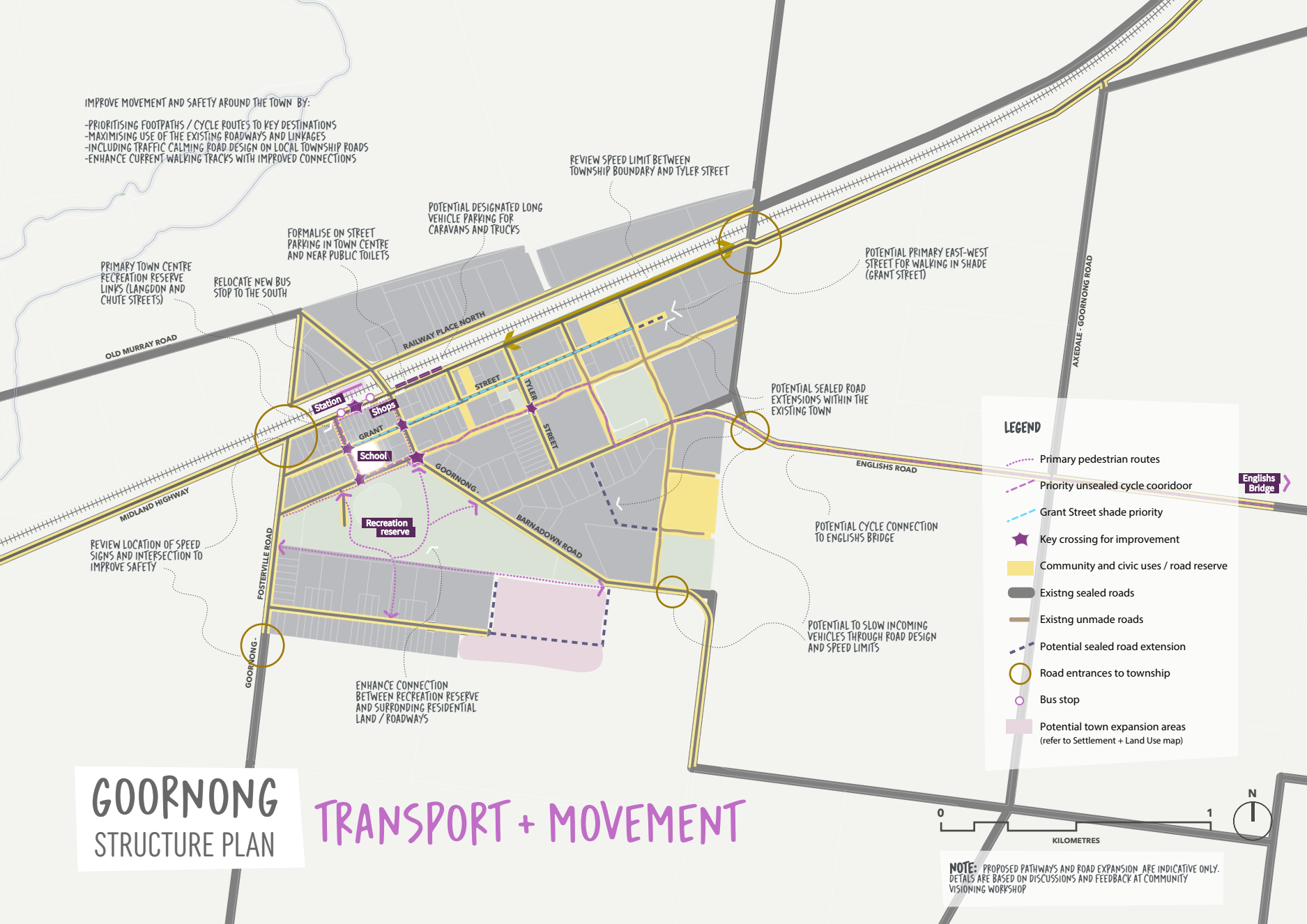

GOORNONG STRUCTURE PLAN

TRANSPORT + MOVEMENT

NOTE: PROPOSED PATHWAYS AND ROAD EXPANSION ARE INDICATIVE ONLY. DETAILS ARE BASED ON DISCUSSIONS AND FEEDBACK AT COMMUNITY VISIONING WORKSHOP

ENHANCE PUBLIC SPACES AND ENVIRONMENT BY:

- MAINTAINING RURAL / PEACEFUL FEEL OF THE TOWN
- INCREASED STREET TREE PLANTINGS IN PRIORITY AREAS (MAIN STREET / GRANT STREET)
- CREATING A SENSE OF ARRIVAL WHEN ENTERING THE TOWN
- EXPANDING ON EXISTING WALKING TRACKS
- PROTECTING VIEW LINES TO SURROUNDING AGRICULTURAL LAND
- USE OF NATURAL DRAINAGE

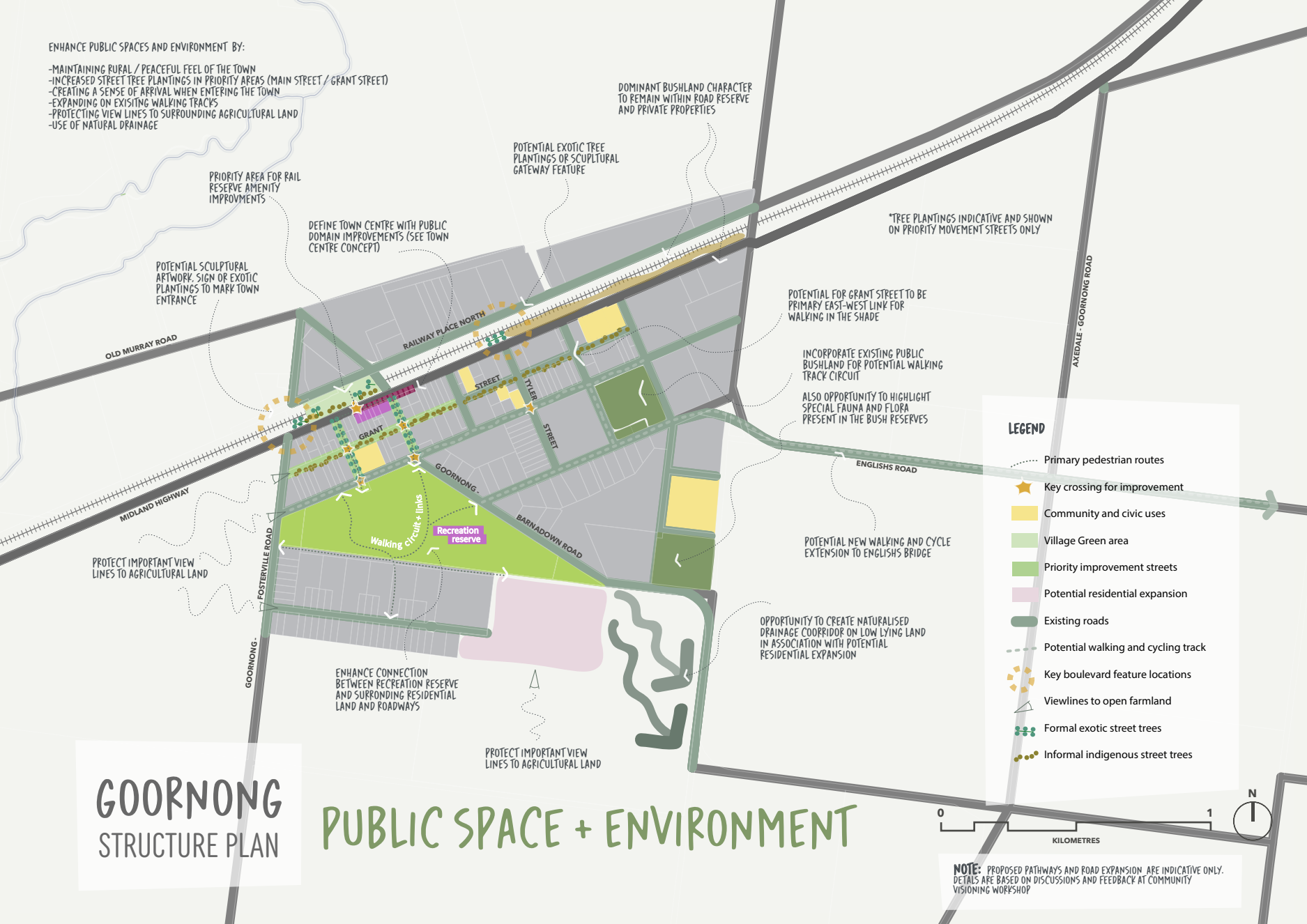

GOORNONG STRUCTURE PLAN

PUBLIC SPACE + ENVIRONMENT

NOTE: PROPOSED PATHWAYS AND ROAD EXPANSION ARE INDICATIVE ONLY. DETAILS ARE BASED ON DISCUSSIONS AND FEEDBACK AT COMMUNITY VISIONING WORKSHOP

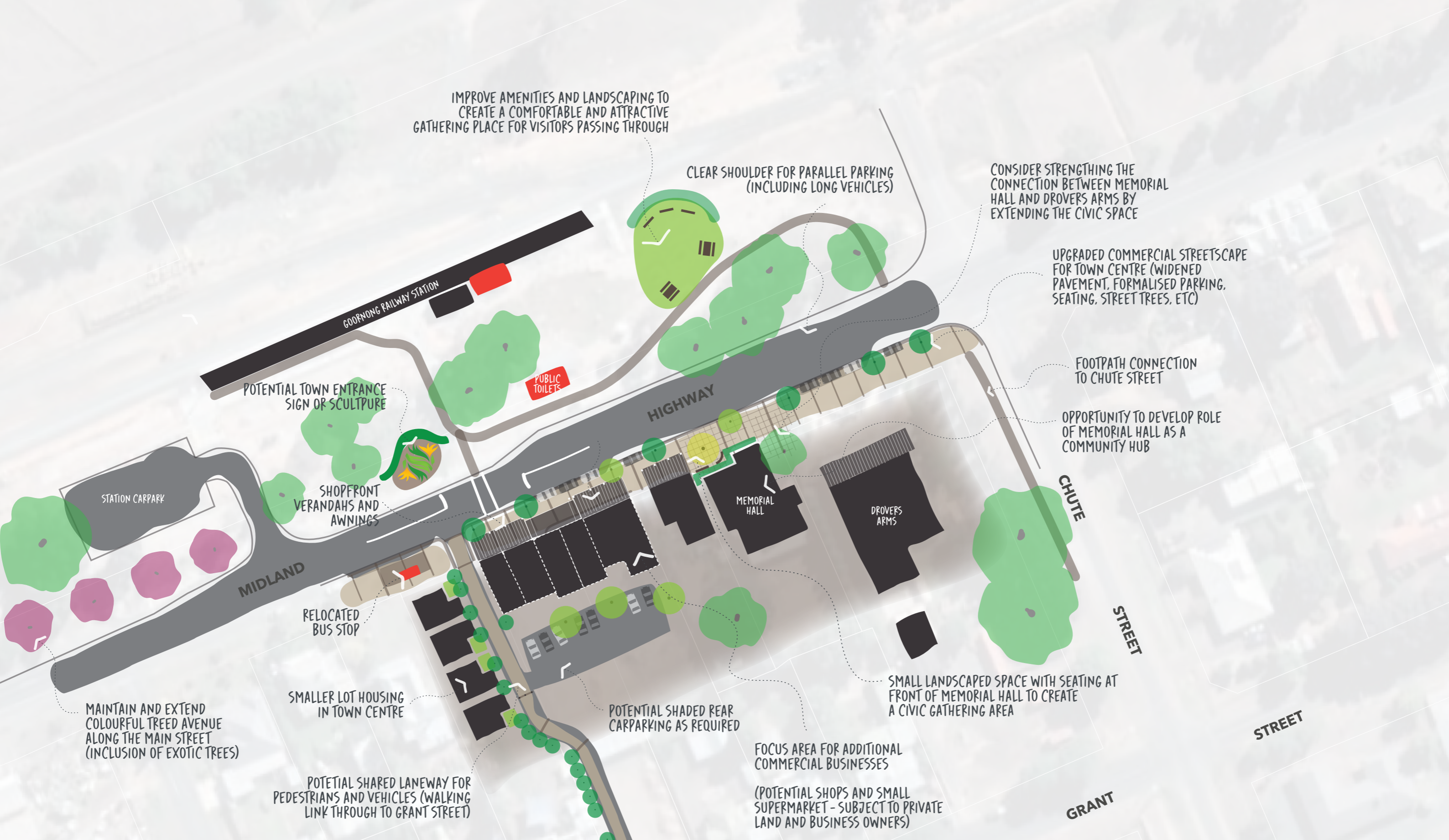

GOORNONG
STRUCTURE PLAN

TOWN CENTRE CONCEPT



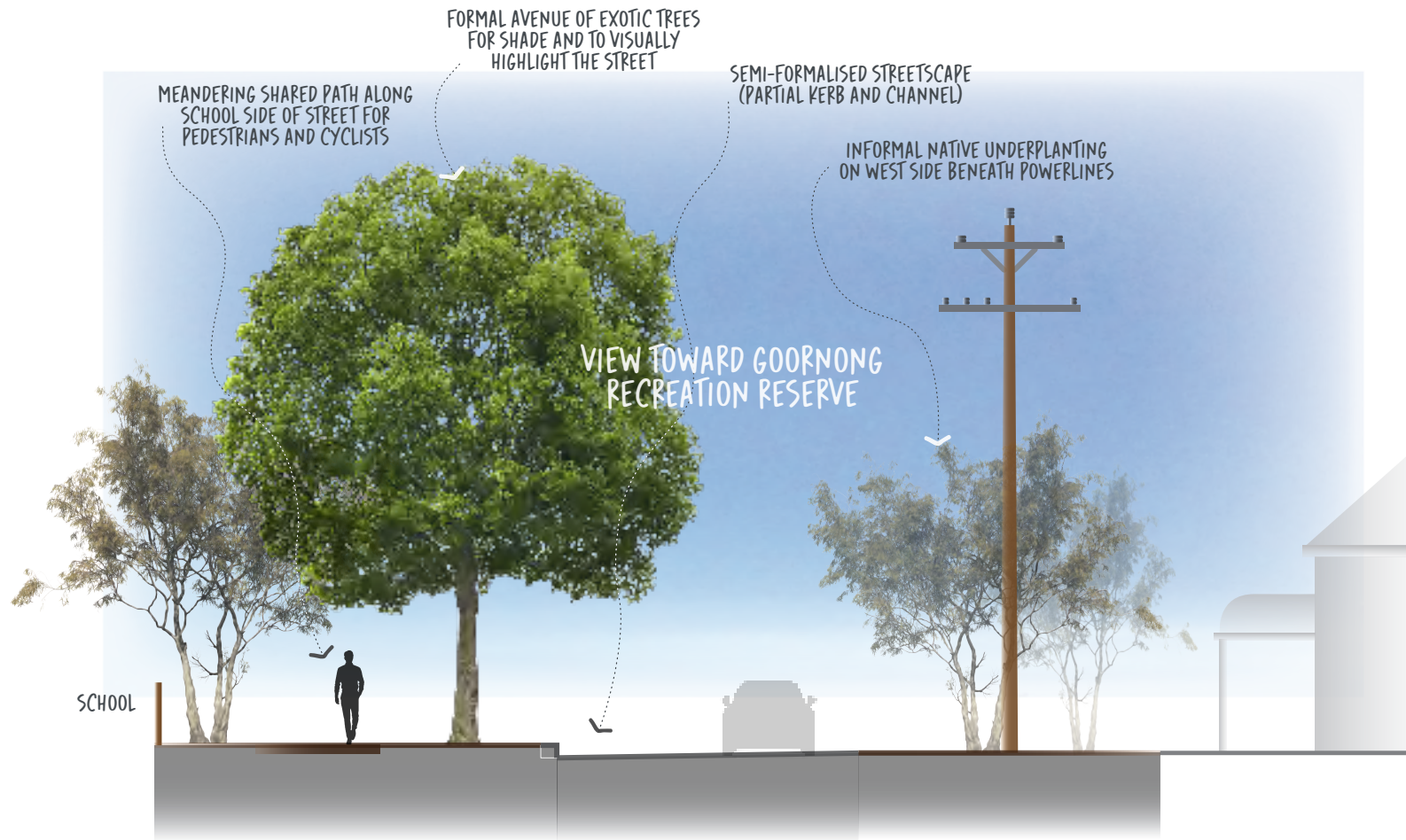

LANGDON AVENUE

TOWN CENTRE TO PARK LINK



BAGSHOT STREET

INFORMAL RECREATIONAL CYCLING TRAIL

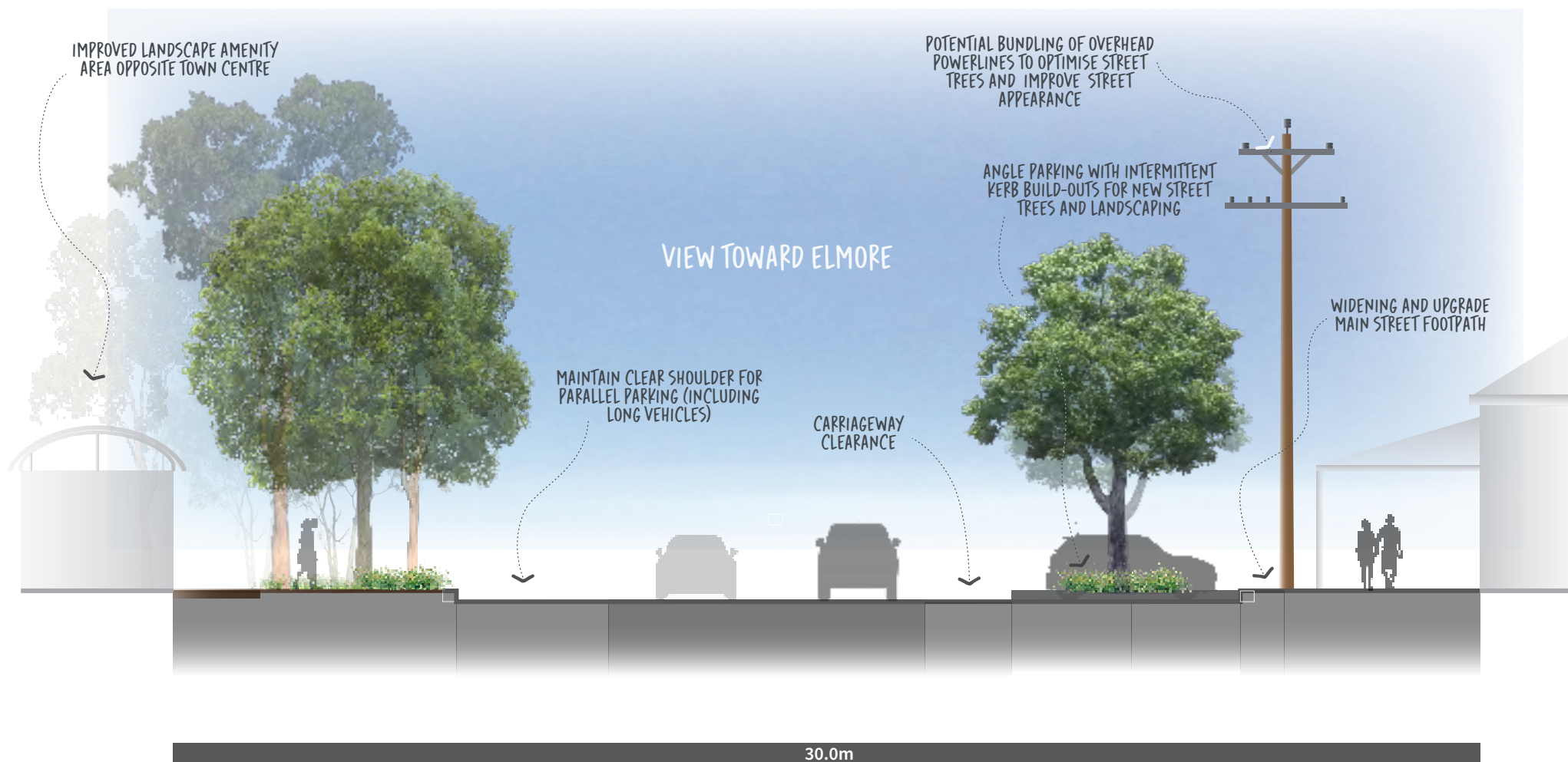

MIDLAND HIGHWAY (RAILWAY PLACE SOUTH)

TOWN CENTRE MAIN STREET